



Whistlers Wood , Hadlow Park, Hadlow, Tonbridge, Kent, TN11 0HY

Guide Price £1,500,000 - £1,600,000

When experience counts...

est. 1828
bracketts

Offered for sale is this immaculately presented five-bedroom executive detached family home located in the private gated development of Hadlow Park and situated close to the centre of the popular village of Hadlow with a comprehensive range of local facilities including village stores, post office, pubs, restaurants, farm shop, library, GP and Dental surgeries, churches and a primary school. Hadlow Park is a sought after location which extends to about 18 acres and is a development of 35 detached houses set in large gardens built in the 1960's. Internally the property comprises large open plan entrance hall, cloakroom WC, dual aspect sitting room, dining room, study, open plan high specification solid wood painted kitchen / breakfast & family room, utility room and a contemporary conservatory. To the first floor family bathroom, large master suite with dressing area and en suite, four further bedrooms with bedroom two & three also complemented by en suite facilities. Externally the property boasts a well-manicured landscaped rear garden mainly laid to lawn with patio area, separate seating area with pergola, external dog shower room and a detached architecturally designed home office gym by local company Curve. There is a double garage with electric up & over door, eaves storage and ample driveway with parking for several

Five Bedroom Detached Family Home

Sought After Hadlow Park

Four Reception Rooms

Modern Open Plan Luxury Solid Wood Kitchen

Utility Room

Modernised Family Bathrooms

Three En Suite Bedrooms

Large Master Suite

Double Garage & Drive

Landscaped Gardens With Detached Home Office / Gym





LOCATION: Tonbridge

Tonbridge is a thriving market town that has developed over the centuries. It boasts a fine example of a 'Motte and Bailey' Norman castle built in the 13th century, set on the banks of the river Medway with the castle grounds abutting Tonbridge Park offering covered/open air swimming pool, tennis courts, childrens' play areas, miniature railway, putting etc.

Tonbridge town offers an excellent range of retail and leisure activities with many High Street stores and a full complement of banks and building societies, together with a selection of coffee shops, restaurants and local inns.

The mainline station provides fast commuter links into London (Cannon Street/London Bridge/Charing Cross in approximately 40 minutes) with road links to the M20 & M25 motorways via the nearby A26 and A21.

Tonbridge offers first-rate primary and secondary schools (including Grammars and Public Schools) many of which consistently do well in the league tables. There are many places of historical interest in the surrounding areas including Penshurst Place and Gardens, Hever Castle, Knole House and Chartwell (once home to Winston Churchill).

ADDITIONAL INFORMATION:

Council Tax Band G

Double Glazed Windows

Gas Central Heating

Air Con to Master Bedroom & Gym

Underfloor Heating in Gym and Master En Suite

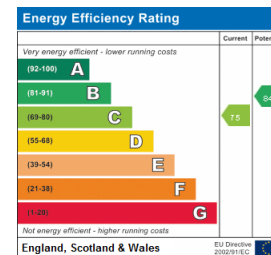

Important Notice: Bracketts, their clients and any joint agents give notice that they have no authority to make or give any representations or warranties in relation to the property. These particulars do not form part of any offer or contract and must not be relied upon as statements or representations of fact. The text, photographs and plans are for guidance only and are not necessarily comprehensive. All areas, measurements or distances are approximate and no responsibility is taken for any error, omission or mis-statement. It should not be assumed that the property has necessary planning, building regulation or other consents and Bracketts have not tested any services, appliances, equipment or facilities. Purchasers must satisfy themselves by inspection or otherwise. Prices, rents or any other charges are exclusive of VAT unless stated to the contrary.



FIRST FLOOR
APPROX. FLOOR AREA
1642 SQ.FT.
(152.59 SQ.M.)

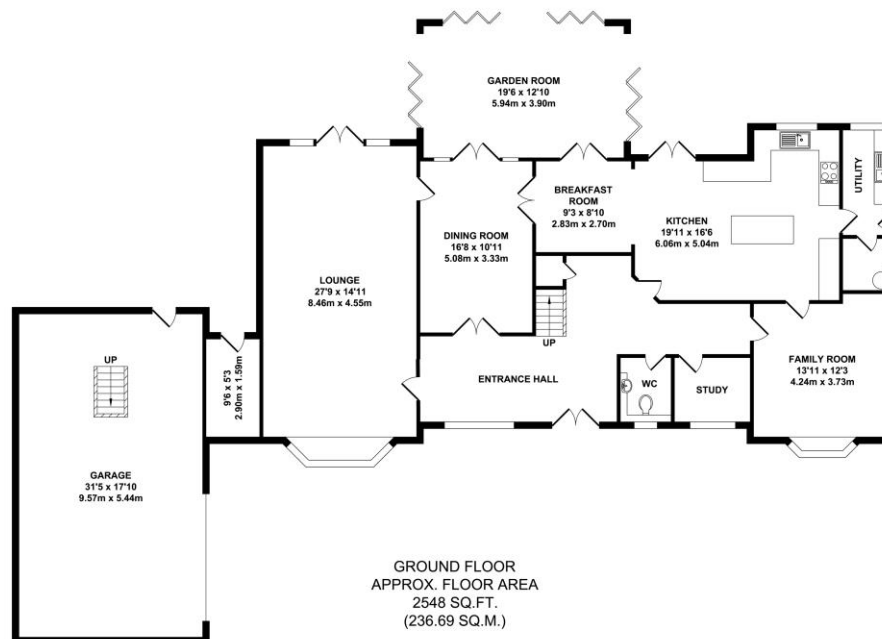

GROUND FLOOR
APPROX. FLOOR AREA
2548 SQ.FT.
(236.69 SQ.M.)

TOTAL APPROX. FLOOR AREA 4306 SQ.FT. (400.03 SQ.M.)

Whilst every attempt has been made to ensure the accuracy of the floor plan contained here, measurements of doors, windows, rooms and any other items are approximate and no responsibility is taken for any error, omission or mis-statement. This plan is for illustrative purposes only and should be used as such by any prospective purchaser. The services, systems and appliances shown have not been tested and no guarantee as to their operability or efficiency can be given.
Zome Media ©2022